

NE NEW MEXICO HISTORIC BUILDING INVENTORY FORM - MISSION CHURCH SURVEY

Identification	building name(s) historico: MARIA SANTISIMA de CONCEPCION current: IMMACULATE CONCEPTION	county SAN MIGUEL	ID no. 1168	
	location description (including street *): IN CONCEPCION NEAR ROMERVILLE, EXIT 1-25 ON ROMERVILLE FOLLOW SOUTH FRONTAGE RD TO COUNTY RD C24, TURN SE AND FOLLOW ROAD 10.6 MILES TO CHURCH (GO THRU SAN AGUSTIN)	UTM reference easting northing	legal description TNSP 14 (N) S range 17 (E) W sec. 1/4 1/4	
	mailing address C/O Sr. & Sra. ROSENDO GONZALES 1017 TILDEN	field map NM Highway Dept Quad	name and number ANTON CHICO # 44	land grant/reservation LAS VEGAS
		city/town LAS VEGAS NM	zip 87701	

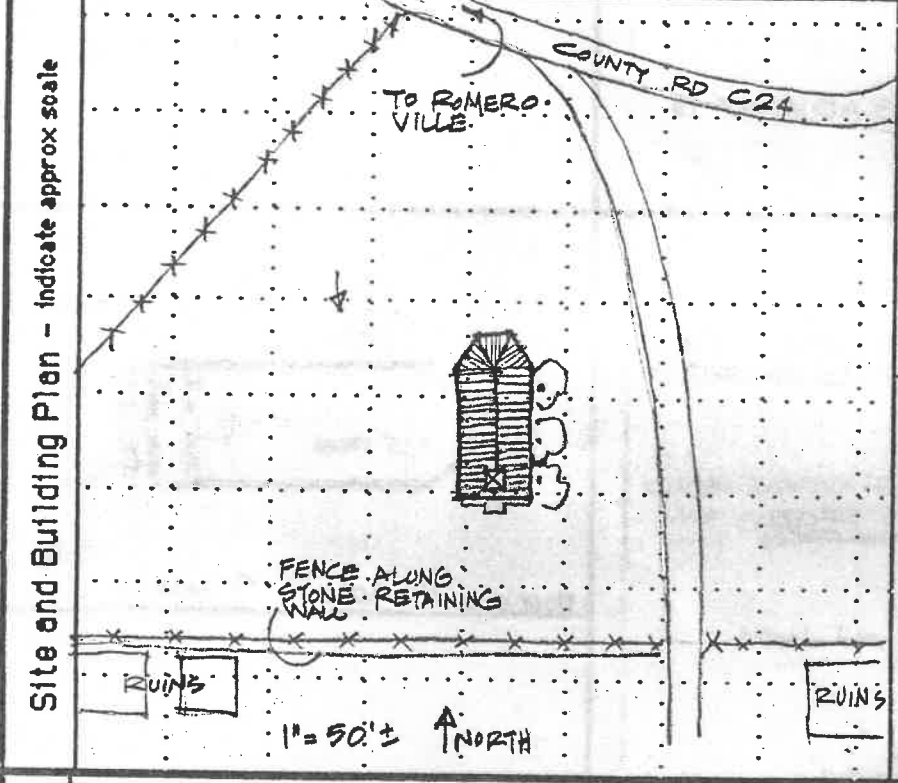

Building Data	date of construction: <u>OR LEAST 100 YRS OLD</u> estimated (actual: _____ source: <u>MRS ROSENDO GONZALES</u>)	Surroundings: residential/commercial <u>urban/rural</u> historic district? _____
	use: historic - church present <u>ABANDONED</u>	location of site relative to town plan: <u>ISOLATED SITE</u> <u>ON EDGE OF FOOTHILLS</u> <u>OVERLOOKING RIVER BOTTOM SURROUNDED BY FIELDS</u>
	structure: foundation <u>STONE</u> walls <u>MUD PLASTER/ADOBES/PAINTED MUD</u> roof <u>PITCHED W/ CORRUGATED METAL</u>	location of campo santo/other site features <u>CAMPO SANTO</u> <u>IS ACROSS ROAD ON HILL</u>
	alterations: <u>minor</u> moderate, major	associated detached buildings <u>NONE</u> what type?
	additions: <u>NONE APPARENT</u>	If inventoried, list ID no. _____
style: traditional <u>(modified traditional)</u>	Significance of the structure: recognition: state reg* _____ national reg* _____ local? eligible? _____ yes _____ no comments:	
architectural features: • PITCHED ROOF W/ BELFRY. WOOD SHINGLES ON BELFRY • CHAIR LOFT • BARREL VAULT CEILING W/ 1/2 DOME ABOVE SANCTUARY • ALL FACED WITH 1X BOARD • CASSED ENTRY DOOR OPENING W/ TERRITORIAL STYLE TRIM	Condition: good _____ fair _____ deteriorating <u>X</u> comments: <u>NEEDS MAJOR REPAIRS TO RAFT, NEW CLOSURES</u> <u>AT ALL OPENINGS, AND REPAIRS TO WOOD FLOOR</u> <u>AND WALL SURFACES</u>	
	Is building threatened? <u>YES</u>	

Surveyed on <u>8/27/86</u> by <u>JBR</u> Johnson-Nestor / Architects, Santa Fe	Photographs by <u>JBR</u> roll* <u>2</u> neg* <u>18</u> to <u>21</u>	Negatives: with NMHPD	Comments Continued on reverse? <u>YES</u>
---	---	--------------------------	--

Site work

drainage: GENERAL SITE DRAINAGE IS NORTH TO SOUTH. ASPE OF CHURCH IS BERMED INTO HILL WITH DRAINAGE AROUND. NO PONDING AREAS VISIBLE

roadways: ADJACENT TO COUNTY RD C24, DRIVEWAY TO OTHER PROPERTIES ALONG EAST SIDE OF CHURCH

other: CEDAR TREES GROWING AT BASE OF EAST WALLS ARE PROBABLY AFFECTING FOOTINGS

ancillary structures:
NONE RUINS OF BUILDING ADJACENT TO CHURCH

Maintenance Needs

Roof: replace:

 repair: ROOF COVERING NEEDS TO BE REPLACED. AND FRAMING REVIEWED FOR ADEQUACY

Walls: base: STONE

 structure: ADOBE WALLS APPEAR SOUND BUT MUD PLASTER IS ERODING ON INSIDE AND OUTSIDE SURFACES

 skin:

Other: openings: WINDOW SASH AND DOORS HAVE BEEN REMOVED

 WOOD FLOORS

 details / ornamentation: TERRITORIAL TRIM W/ DENTILS AT HEAD OF DOOR. CHOR POSTS HAVE CHAMFERED EDGES.

Parish

archdiocese:

parish: NOT APPLICABLE

priest:

Community

mayordoma/mayordomo: —

parish council: —

other: SEÑOR PIFANÓ JARAMILLO IS OWNER OF PROPERTY, AND LIVES IN TEXAS
MR & MRS ROSENDO GONZALES FURNISHED INFORMATION RE HISTORY 425-7416
professionals engaged:

